

ANVIZ

Invent • Trust

VF30 | VP30

Fingerprint access control and time attendance



Fashionable and graceful Secure and reliable



VF30 fingerprint access control and time attendance is a professional access control system developed for small to medium size businesses for security. It integrates fingerprint identification, RFID, burglar alarm, time attendance and access control functions etc., with fashionable and elegant appearance and reliable quality. It has high quality musical buzzer, multiple language display, user friendly interface and powerful communication function suitable for data management in various environments. It comes with functional background management software, compatible with various types of database. It supports time zone and group access control real-time monitoring for high security level. It is versatile, convenient and multi-functional.

This product can be widely used in offices, buildings, warehouses, secret organizations, archive rooms, server rooms, intelligent residential areas etc.



VF30



VP30



Time zone access control



Perfect combination of fingerprint and card

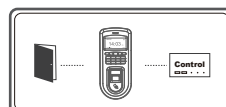

Separate type secure access control

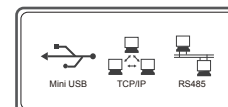

Multiple communication methods

CE FC ISO 9001 RoHS COMPLIANT

Technical parameter

Fingerprint sensor	Anviz new generation waterproof and dustproof optical sensor (VF30)	Working current	<450mA
LCD	132*64 white LCD	Sleeping current	<180uA
Identification method	FP, Card, Password	Power	DC12V 1A
Identification time	≤0.5 second	Temperature/humidity	-10°C-60°C / 20%-80%
Register method	Card, FP, Password	Casing material	ABS industrial plastic
Register capacity	VF30 : 2000(FP), VP30 : 20000(FP)	Size	80(w)*180(h)*40(d)mm
Record capacity	VF30 : 50000, VP30 : 200000	Color	Black (Customizable)
FRR	0.001%	Scan area	22mm*18mm
FAR	0.00001%	Resolution	500DPI
Standard port	Wiegand 26, doorbell output, door sensor, relay for electric lock		

Product feature

- USA technology with Anviz optical waterproof fingerprint sensor. Scratch-proof, unbreakable and durable. Well accept all kinds of fingerprints
- BioNano core algorithm platform of high performance and reliability
- New 2010 version algorithm with improved performance on wet and dry fingerprints. Support identification from different angles
- Multiple languages including English, French, Spanish, Portuguese and Chinese etc.
- White backlit keypad with 10 numeric keys and 7 function keys
- VF30: standard fingerprint reader, optional RFID/Mifare/HID card reader
- VP30: standard RFID card reader, optional Mifare/HID card reader
- Mini USB, RS485 and TCP/IP for network connection
- Support wiegand input/output up to 90 meters. Tamper alarm output to connect with alarm equipment outside. Alarm card No. can be sent to controller by Wiegand 26
- Door sensor alarm monitor the status of the door.
- Direct lock control to open door. Optional SC021/SC822 access controller or any other standard access controller for separate type secure access control system
- Unique infrared auto wakeup design
- Support realtime record download and WEB online tracking function
- Time zone and group access control, realtime data transfer monitor
- Identification method: FP, Card, Password
- VF30: standard 5000 fingerprints and 50000 records
- VP30: standard 20000 card users and 200000 records
- Wall mounted, combine 2-in-1 function for access control and time attendance

Outline drawing

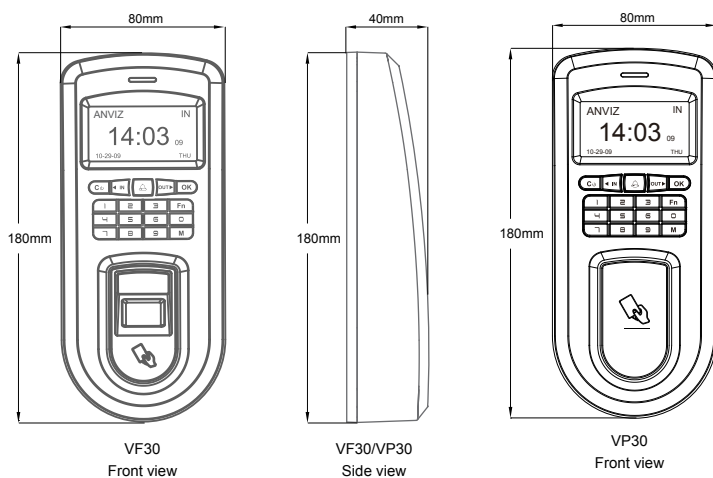

Typical installation



Enterprise



Hotel



Building



Government



Finance company



Education and training organization

Network topology illustration

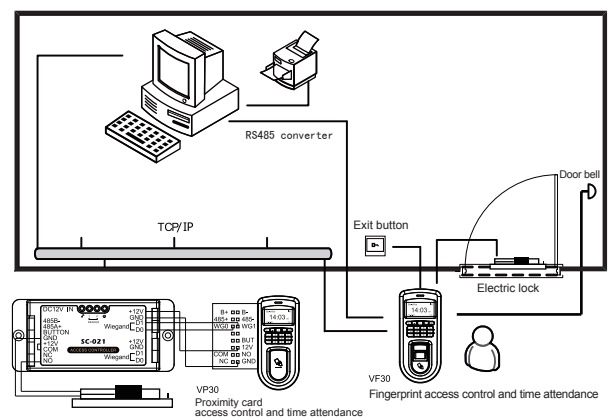

Single door separate type access control solution